



JOHN DEERE

INSTALLATION INSTRUCTIONS

100 Series Power Lift Kit

3-413 3/01/2024

ENGLISH

LP68150

Introduction

Using Your Operator's Manual

Read this entire operator's manual, especially the safety information, before operating.

This manual is an important part of your machine. Keep all manuals in a convenient location so they can be accessed easily.

Use the safety and operating information in the attachment operator's manual, along with the machine operator's manual, to operate and service the attachment safely and correctly.

If your attachment manual has a section called Preparing the Machine, it means that you will have to do something to your tractor or vehicle before you can install the attachment. The Assembly and Installation sections of this manual provide information to assemble and install the attachment to your tractor or vehicle. Use the Service section to make any needed adjustments and routine service to your attachment.

If you have any questions or concerns with the assembly, installation, or operation of this attachment, see your local John Deere dealer or call the John Deere Customer Contact Center at 1-800-448-9282 for assistance.

Warranty information on this John Deere attachment can be found in the warranty that came with your John Deere tractor or vehicle.

Original instructions. All information, illustrations and specifications in this manual are based on the latest information available at the time of publication.

The right is reserved to make changes at any time without notice.

Table of Contents

Introduction	2
Product Compatibility	2
Safety Labels	3
Safety	4
Assembly	5
Installation	6
Adjustment and Operation	9
Removal and Storage	10
Warranty	11

Product Compatibility

Compatible with BM26888 Snow Blower kits for 100 Series and S240 lawn tractors. Provides power lift capability for snow blower attachment.

NOTE: Retain these installation instructions with the machine operators manual.

Safety Labels

Safety Label Location

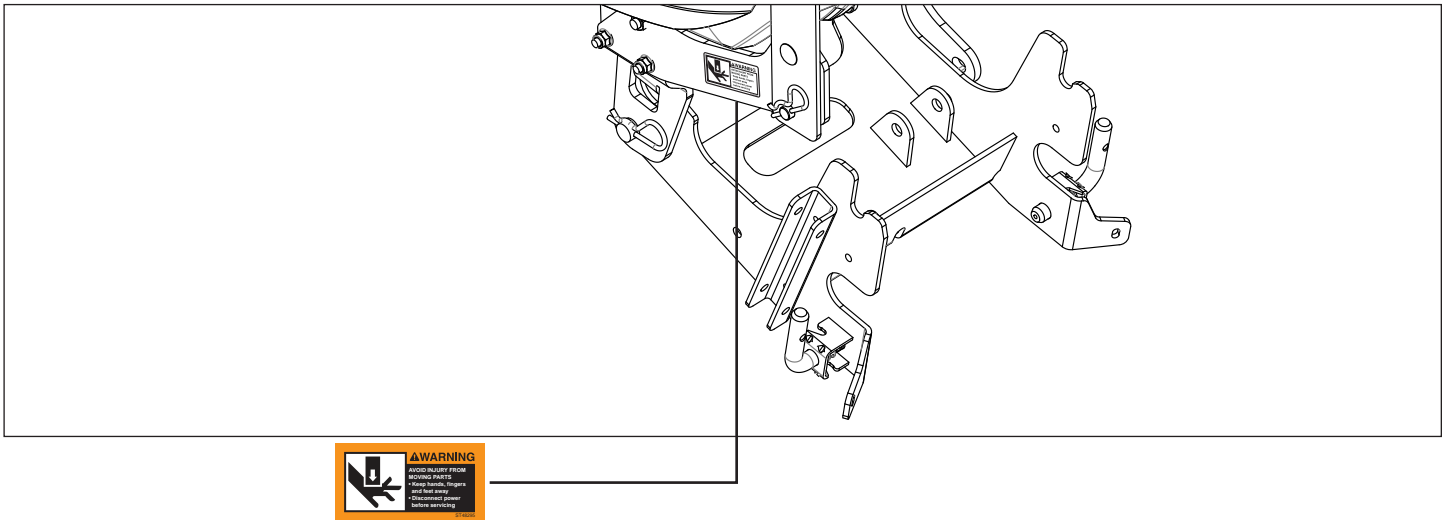

Understanding The Machine Safety Labels



The machine safety labels shown in this section are placed in important areas on your machine to draw attention to potential safety hazards.

On your machine safety labels, the words **DANGER**, **WARNING**, and **CAUTION** are used with this safety-alert symbol. **DANGER** identifies the most serious hazards.

The operator's manual also explains any potential safety hazards whenever necessary in special messages that are identified with the word, **CAUTION**, and the safety-alert symbol.

Replace missing or damaged safety labels. Use this operator's manual for correct safety label placement.

There can be more safety information contained on parts and components sourced from suppliers that is not reproduced in this operator's manual.

Warning

Avoid Injury From Moving Parts



- Keep hands, fingers and feet away
- Disconnect power before servicing

Safety

Practice Safe Maintenance

- Only qualified, trained adults should service this machine.
- Understand service procedure before doing work. Keep area clean and dry.
- Do not operate the engine in a confined space where dangerous carbon monoxide fumes can collect.
- Never lubricate, service or adjust the machine or attachment while it is moving. Keep safety devices in place and in working condition. Keep hardware tight.
- Keep hands, feet, clothing, jewelry, and long hair away from any moving parts, to prevent them from getting caught.
- Lower any attachment completely to the ground or to an existing attachment mechanical stop before servicing the attachment. Disengage all power and stop the engine. Lock park brake and remove the key. Let machine cool.
- Disconnect battery or remove spark plug wire (for gasoline engines) before making any repairs.
- Before servicing machine or attachment, carefully release pressure from any components with stored energy, such as hydraulic components and springs.
- Release hydraulic pressure by lowering attachment or cutting units to the ground or to a mechanical stop and move hydraulic control levers.
- Securely support any machine or attachment elements that must be raised for service work. Use jack stands or lock service latches to support components when needed.
- Never run engine unless park brake is locked.
- Keep all parts in good condition and properly installed. Fix damage immediately. Replace worn or broken parts. Replace all worn or damaged safety and instruction decals.
- Check all hardware at frequent intervals to be sure the equipment is in safe working condition.
- Do not modify machine or safety devices. Unauthorized modifications to the machine or attachment may impair its function and safety
- Death or serious injury will result from contact with overhead power lines. Keep clear of electrically charged power lines. Check the area before operating the spreader.

Wear Appropriate Clothing



- Always wear eye protection when operating the machine.
- Wear close fitting clothing and safety equipment appropriate for the job.
- While operating this machine, always wear substantial footwear and long trousers. Do not operate the equipment when barefoot or wearing open sandals.
- Wear a suitable protective device such as earplugs. Loud noise can cause impairment or loss of hearing.

Assembly

NOTE: Retain these installation instructions with the machine operators manual.

Parts in Kit - Controls, Brackets, and Electrical

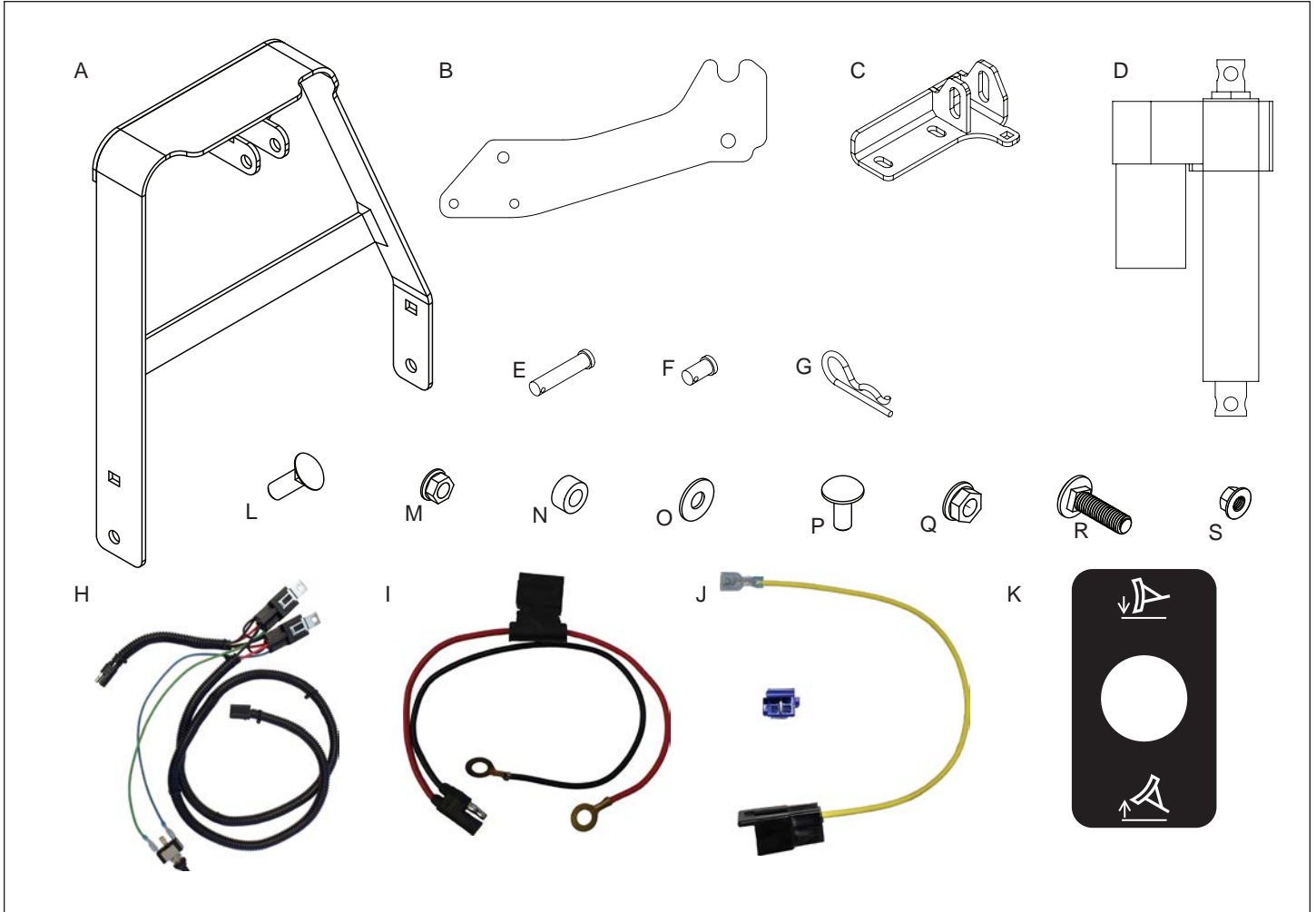

Parts Description	Qty
A-frame Assembly (A)	1
Side Plates (B)	2
Lift Bracket (C)	1
Actuator (D)	1
Clevis Pin 2.25 in (E)	2
Clevis Pin .75 in (F)	2
Hairpin Clips (G)	4
Harness, Relay and Switch (H)	1
Harness, Battery (I)	1
Power Wire with Splice (J)	1
Label "Up/Down" (K)	1

Parts Description	Qty
3/8" x 1" Carriage Bolt (L)	2
3/8" Hex Whiz Lock Nut (M)	2
.75" OD Spacer (N)	2
3/8" Washer (O)	2
5/16" x 3/4" Carriage Bolt (P)	1
5/16" Hex Whiz Lock Nut (Q)	1
M10 x 35mm Carriage Bolt (R)	2
M10 Hex Flange Nut (S)	2
Wire Harness Clip (Not Shown)	2
Wire Ties (Not Shown)	10

Installation

Parking Safely

1. Stop machine on a level surface.
2. Disengage mower blades or any other attachments.
3. Lower attachments to the ground.
4. Lock the park brake.
5. Stop the engine and allow to cool.
6. Remove the key.
7. Wait for engine and all moving parts to stop before you leave the operator's seat.
8. Close fuel shut-off valve, if your machine is equipped with one.
9. Disconnect the negative battery cable or remove the spark plug wire (for gasoline engines) before servicing the machine.

Preparing the Machine

Install Wiring Components

1. Lift the red terminal boot away from the battery terminal and slide it down the positive (red) battery cable. Disconnect the positive (red) battery cable from the battery terminal.
2. Slide the ring terminal and red wire (A) into the red terminal boot (B) and align it with the positive (red) battery cable (C). Connect the cables to the positive battery terminal (D). Do not connect the negative yet. Make sure that the rubber boot is able to cover all of the positive terminal connections.

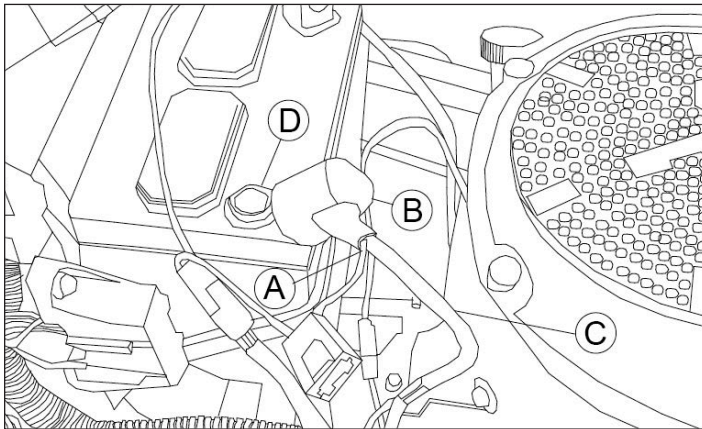

3. Locate a spot on the right side of the dash to mount the switch. Check the backside of the dash for proper clearance. Place the sticker on the dash in the desired location and drill a 15/32" hole.
4. Mount the switch to the dash with the green wire to the top. The yellow wire should be plugged into the center switch terminal.

5. Models E140, E150, E160, E170, E180 and S240: Connect the yellow wire plug to the power port (E).

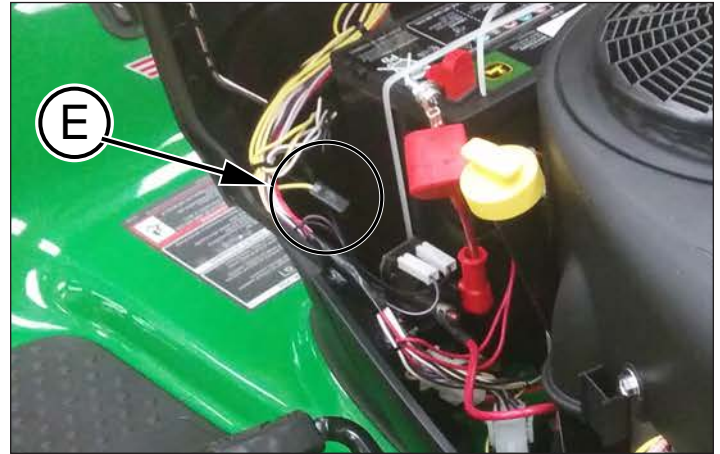

Models missing the power port: Cut the yellow wire power port adapter plug off the relay harness and use the provided quick splice to tap into the yellow power wire in position F on the key switch connectors shown below.

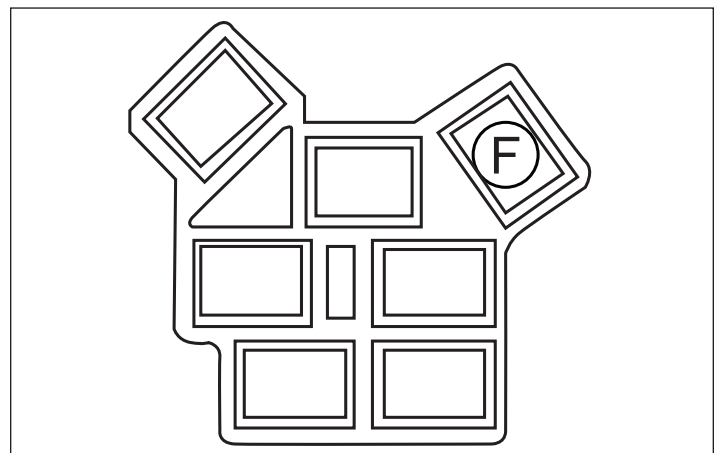
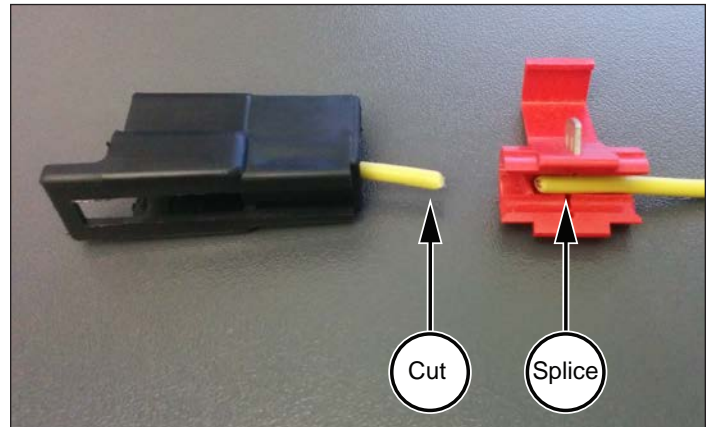

Note: Splice to the yellow wire located in position F on the harness side of the key switch connector.

Installation

6. Route the extension wire from the harness along the tractor's light cable. Wire tie to the light cable at the four positions indicated (J) to prevent the wire from interfering with the exhaust. Trim zip ties to length.

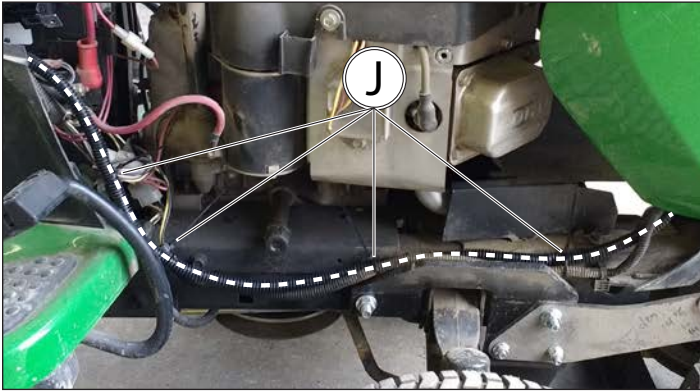

7. Continue routing the extension wire along the tractor's light cable. Secure at the positions shown (K) to prevent the wire harness from interfering with the exhaust. Trim the zip ties to length. Secure harness to the inside of the grill with adhesive backed harness clip (L). Pass the remainder of the extension harness and plug through the grill (M).

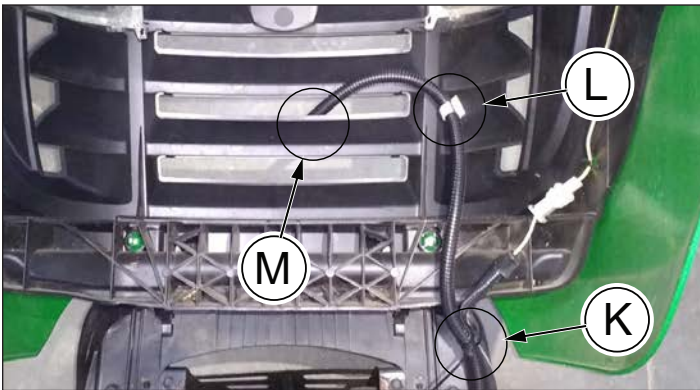

8. Place the relays beside the battery and wire tie the harness to other cables (N) to limit their movement.

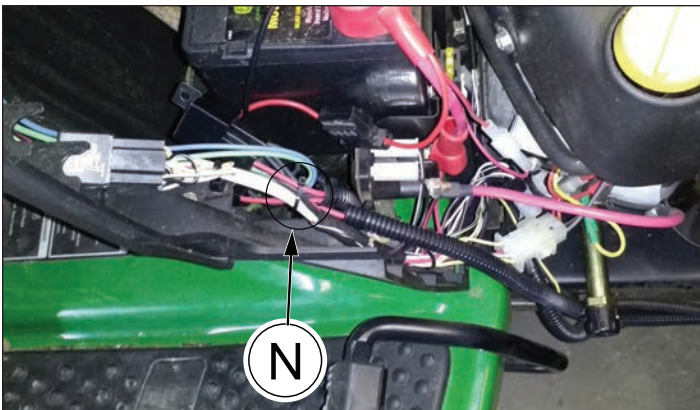

9. Make sure the key is in the off position and connect the negative battery cable and power lift ground lead to the negative battery terminal.

Installing Lift

1. Remove the snow blower from the lift frame.
2. Remove the cotter pin (A) from the lift lock pin and disassemble the spring pin. Remove the pull cable from the lock pin.

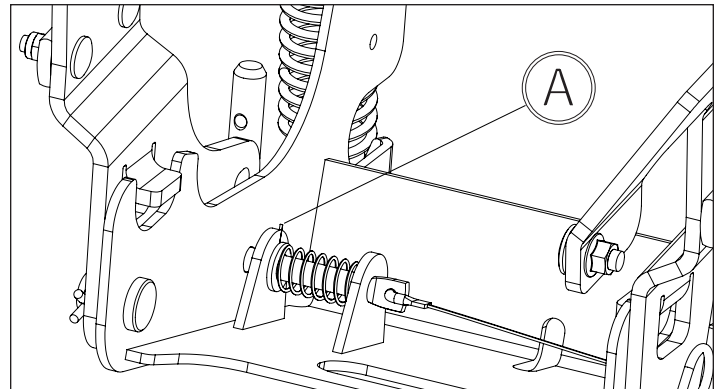

3. Unbolt (B) and remove the lift hand assembly and pull cable.

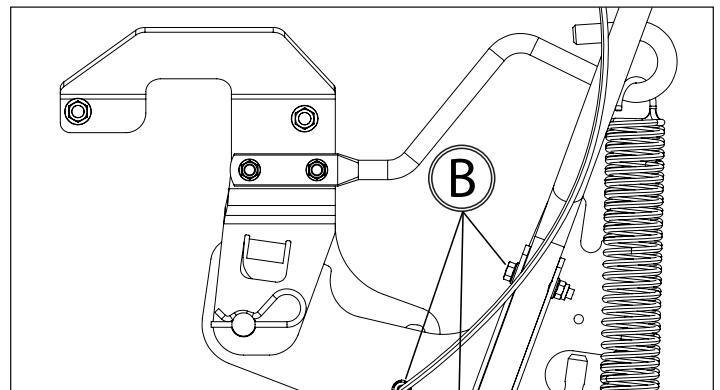

4. Remove the lift springs (C).

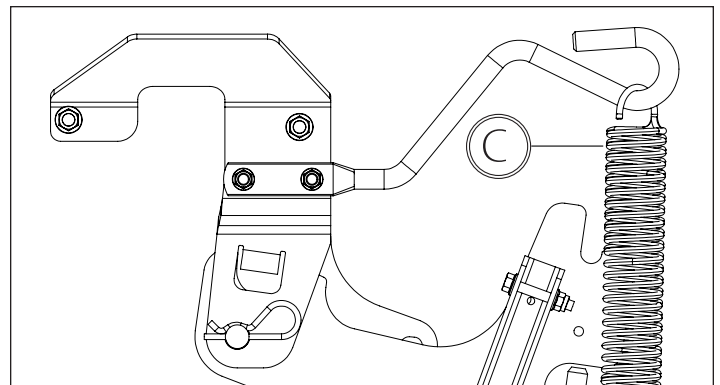

Installation

- Remove the spring hanger brackets by removing the M8 nuts (D).

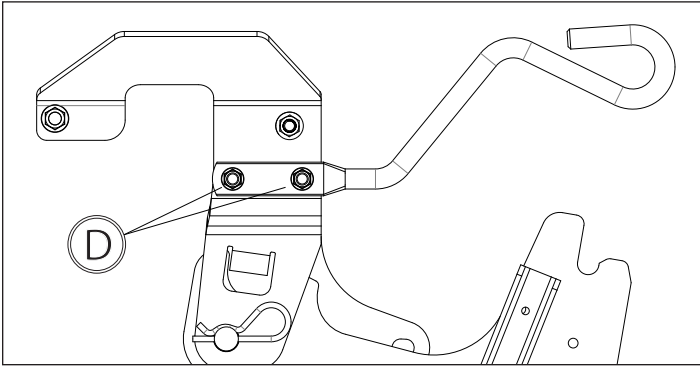

- Install the side mounting plates onto the lift frame using the three bolts (E). Use the provided M10 x 35mm bolt to replace the M10 x 25mm bolt. Torque the M10 nut to 40 ft-lbs. Torque the M8 nut to 18 ft-lbs. Repeat on the other side.

One side plate has a safety label applied to it. Mount this one to the right side of the vehicle frame.

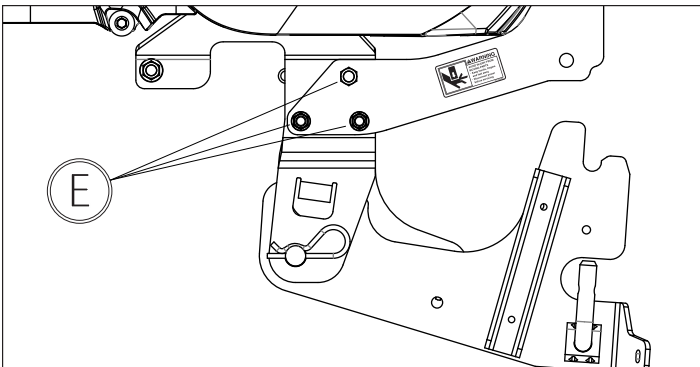

- Install one carriage bolt (L) through upper hole on the lower part of the A-Frame (A). See picture below. Then install one spacer (N), washer (O), and nut (M). Tighten hardware. Repeat on the other side.

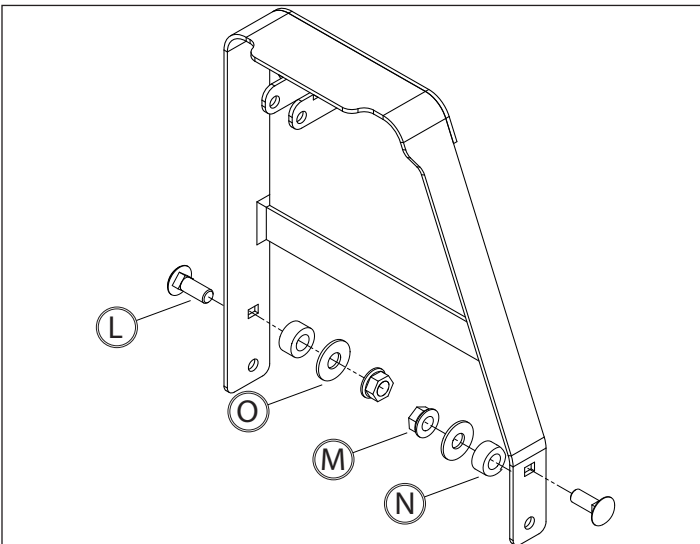

- Mount the A-frame to the side plates by engaging the spacers into the slots (F) and inserting the pins through the lower holes. Secure with the hairpin clips (G). For adjusting the A-frame, see the Adjustments section.

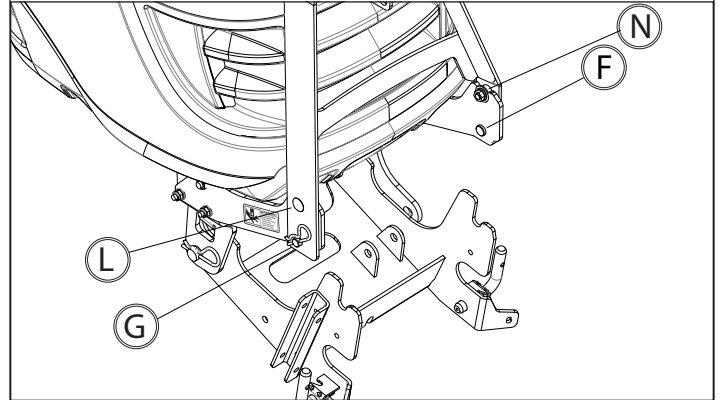

- Hang the actuator (D) from the A-frame (A) and secure with the clevis pin (E) and the hairpin (H). Connect the actuator plug to the electric harness plug (H) through the slots in the hood grill. (Tractor not shown)

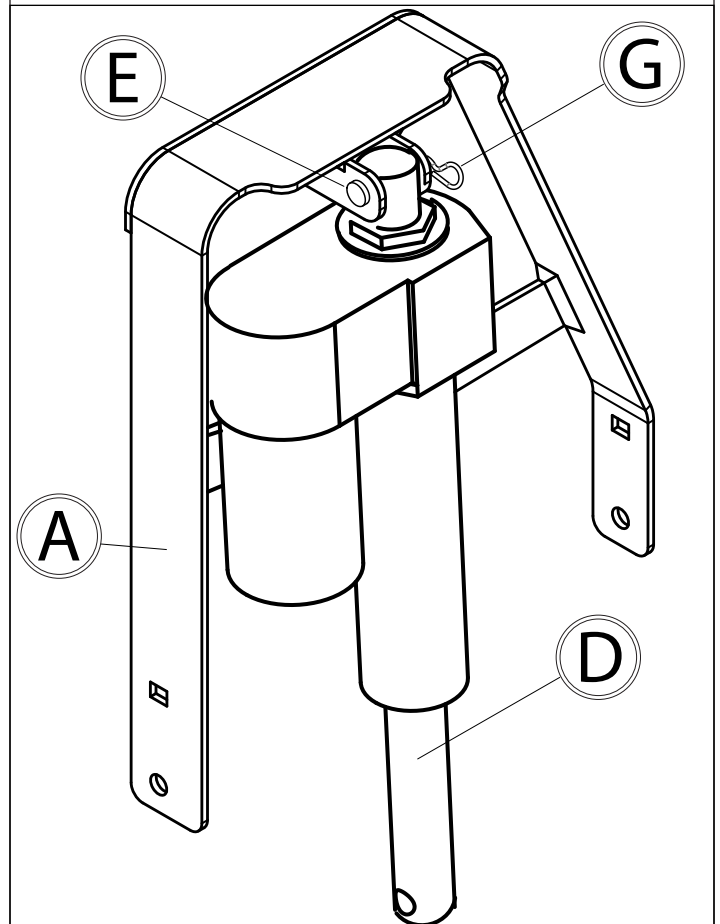

Installation

10. On the snow blower, remove the two bolts (1) from the gearbox and install the lift bracket (C) re-using bolts (1). Install a 5/16" carriage bolt (P) into the hole and secure with a 5/16" hex nut (Q). Torque to 18 ft-lbs.

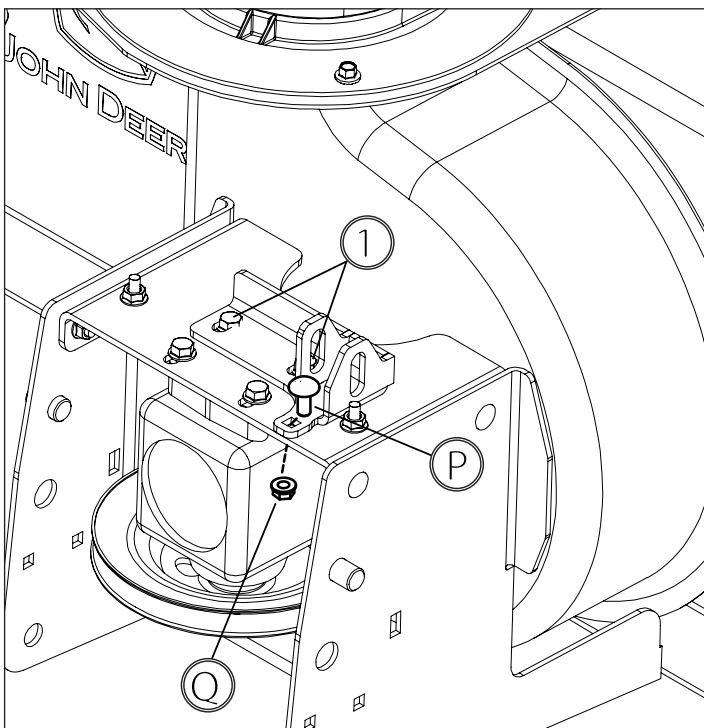

11. Extend the actuator (D) by manually turning the cylinder. The actuator (D) should be extended approximately 3 inches in order to attach to the snow blower lift bracket (C).

12. Install the snow blower onto the lift frame and lock into place.

13. Place the actuator cylinder into the lift bracket slot. Install clevis pin (E) from right side into the lift bracket (C), actuator cylinder, and through other side of the lift bracket (C). Secure with hairpin clip (G).

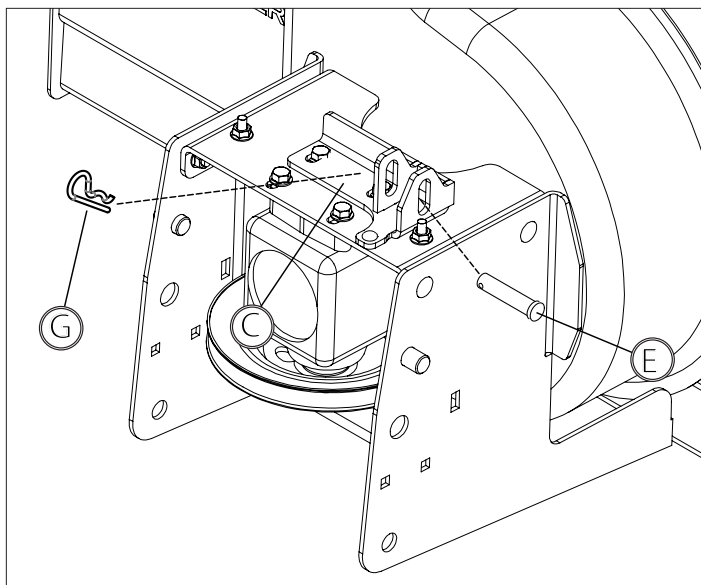

CAUTION: Attachment can lower rapidly. Keep bystanders away from attachment when raising and lowering.

Adjustments and Operation

Adjustment

1. If the A-frame is not standing vertical, loosen the 3/8" bolts (L) and adjust the A-frame forward or backwards to make it vertical and retighten the bolts to 32 ft-lb.

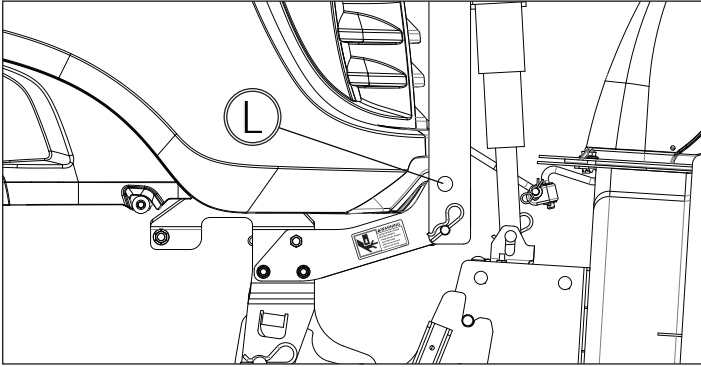

Operation

The electric lift enables you to easily lift the snow blower attachment and can apply down force to the snow blower. Drive at slow speeds when using the attachment. Be cautious of hidden obstacles.

To open hood of the vehicle, follow steps 1 through 4 in the Removal section.



CAUTION: Attachment can lower rapidly. Keep bystanders away from attachment when raising and lowering.

Removal and Storage

Removal

1. Raise or lower the actuator so that the snowblower is on the ground and the lower actuator pin is loose and can be removed.



CAUTION: Attachment can lower rapidly. Keep bystanders away from attachment when raising and lowering.

2. Unplug the actuator from the electrical harness.
3. Remove the lower actuator clevis pins. Remove the upper actuator clevis pin and detach the actuator.
4. To remove the A-frame, first remove the pins (A) at the bottom of the A-frame. Hold the A-frame to keep it from rotating as the second pin is being removed. Lift the A-frame away.

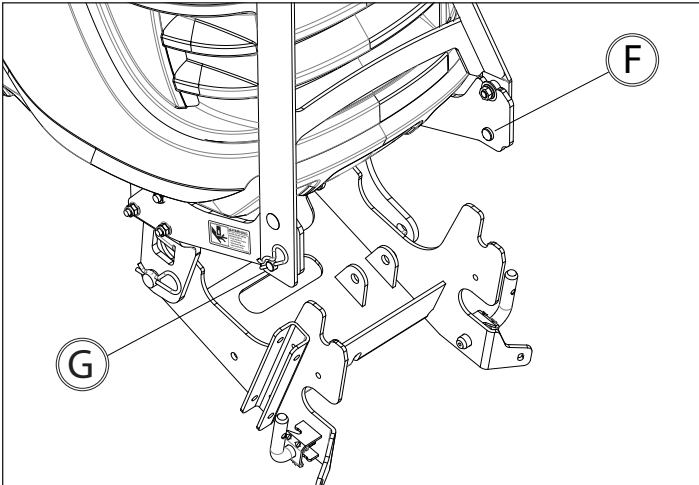

5. Remove the snow blower and hitch from the tractor as described in the snow blower operator's manual.



CAUTION: Avoid injury! Touching hot surfaces can burn skin. The engine, components, and fluids will be hot if the engine has been running. Allow the engine to cool before servicing or working near the engine and components.

Good Quality Service

John Deere Quality Continues with Quality Service

John Deere provides a process to handle your questions or problems, should they arise, to ensure that product quality continues with quality parts and service support.

Follow the steps below to get answers to any questions you may have about your product.

Refer to your attachment and machine operator manuals.

In North America or Canada, call Agri-Fab at 1-800-448-9282 and provide product serial number (if available) and model number.

Warranty

Limited Warranty for New John Deere Licensed Products

Agri-Fab's 100 Series Lift Kits are guaranteed to be free from defects in material and workmanship from the date of purchase for 2 years residential use, 6 months commercial use, provided that the purchaser properly assembles, installs, uses and maintains the products in accordance with this manual.

Purchaser's failure to adhere to such requirements will void the warranty. To the extent permitted by applicable law, all other warranties, representations, obligations and conditions, expressed or implied, including but not limited to implied warranties of merchantability, fitness for any particular purpose and non-infringement, are hereby disclaimed and excluded.

Any product which does not meet warranty shall, as purchaser's sole and exclusive remedy, be repaired or replaced by Agri-Fab. This warranty is non transferable.

In addition, our warranty does not cover:

- Labor charges
- Loss or consequential, incidental or special damages of any kind
- Electric actuators for more than one year

This product was manufactured by Agri-Fab, Inc, a John Deere Licensee, located at 809 S Hamilton St, Sullivan, IL 61951. If you have any questions or concerns with the assembly, installation, or operation of this attachment, see your local John Deere dealer or call Agri-Fab at 1-800-448-9282 for assistance.

